

\$499,900 - Hwy 623 Range Road 245, Rural Leduc County

MLS® #E4436184

\$499,900

0 Bedroom, 0.00 Bathroom,
Rural on 4.00 Acres

None, Rural Leduc County, AB

Bordering the City of Leduc & on pavement, 4 acres, NOT IN A SUBDIVISION, 40 X 80 heated shop with full concrete floor, infrared radiant heating, metal clad in & out for low maintenance & longevity, well lit with fluorescent lighting, six skylights for natural light & a 20 x 14 ft overhead door with electric door opener. Natural gas & electricity on site. A great place to build your dream home and have room for all the toys.



Essential Information

MLS® #	E4436184
Price	\$499,900
Bathrooms	0.00
Acres	4.00
Type	Rural
Sub-Type	Vacant Lot/Land
Status	Active

Community Information

Address	Hwy 623 Range Road 245
Area	Rural Leduc County
Subdivision	None
City	Rural Leduc County
County	ALBERTA

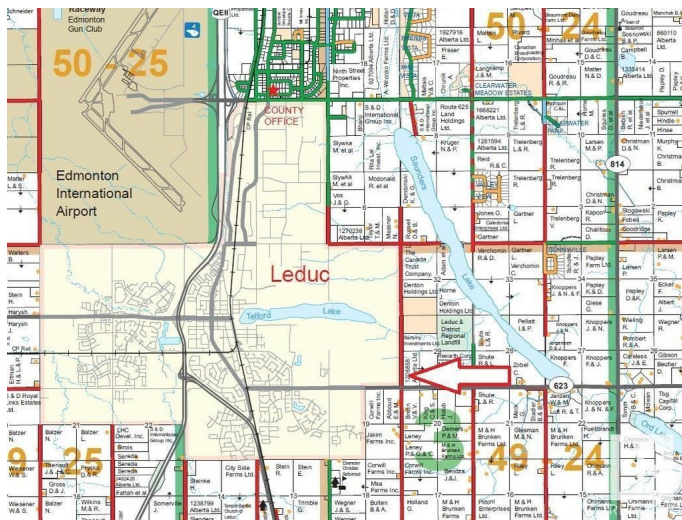

Province AB
Postal Code T9E 2X2

Interior

Heating See Remarks, Natural Gas

Exterior

Exterior Features Flat Site, Landscaped, Level Land, No Through Road, See Remarks
Lot Description 118.9 x 137.2 meters

Additional Information

Date Listed May 13th, 2025
Days on Market 81
Zoning Zone 80

DATA IS DEEMED RELIABLE BUT IS NOT GUARANTEED ACCURATE BY THE REALTORS® ASSOCIATION OF EDMONTON. COPYRIGHT 2025 BY THE REALTORS® ASSOCIATION OF EDMONTON. ALL RIGHTS RESERVED.Trademarks are owned or controlled by the Canadian Real Estate Association (CREA) and identify real estate professionals who are members of CREA (REALTOR®, REALTORS®) and/or the quality of services they provide (MLS®, Multiple Listing Service®)
Listing information last updated on August 2nd, 2025 at 1:17am MDT